

# STERLING

## DependaVac 12

(Part # 135-1350-20)



Thank you for choosing Sterling's DependaVac 12 upright vacuum. This commercial appliance is well constructed and should provide you with years of professional service if you take the time to read this manual. For your information, this vacuum was protectively packed to prevent possible damage in transit. Should damage occur, please notify the transporting carrier immediately for loss and/or claim. It is also important to learn the steps for proper assembly, operation and maintenance. It will also make the product easier to use and save you even more time and money. We suggest you keep this manual at hand for future reference. We stand behind this product and can help anytime with a knowledgeable and dedicated customer service staff. Please contact us anytime at 844-822-7787 or SterlingNA.com

**Unpackaging the Vacuum** - When the machine is delivered, carefully inspect the shipping carton and the machine for damage. If damage is evident, save the shipping carton so that it can be inspected. Contact Sterling Customer Service Department so a freight claim can be filed.

## MACHINE ASSEMBLY

- 1. Locate Assembly Packet** - A packet is included with vacuum and includes two (2) 2-part bolts and two (2) cord hooks. Also included is an extra drive-belt.

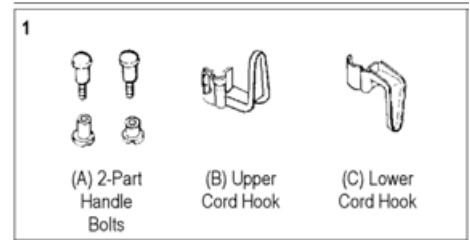

- 2. Attach Lower / Upper Handle** - Slide the upper handle (D) and the lower handle (E) together so the holes for the handle bolts are aligned and the slots in the handle are positioned as shown in Figure 2. Insert a 2-part bolt (A) in the center of the handle and fasten tightly. Position the assembled handle (D/E) so it curves toward the operator. Push the handle into the handle socket (F) at the rear of the cleaner. Align the holes, insert the other 2-part bolt (A) and tighten.

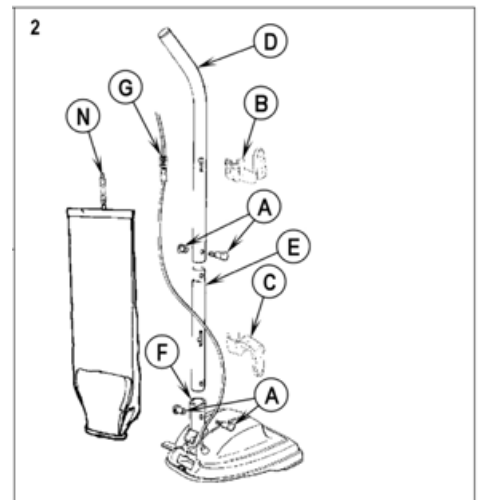

**3. Attach Upper Cord Hook** - Pull the spring (G) on the cord upward toward the top of the handle. Insert the lower half of the spring (G) into the upper cord hook (B). Make sure slots in handle are positioned properly (Figure 2). Place inner tab into slot as shown in (1) and press hook around handle (2), snapping opposite inner tab into place (3) (Figure 4).

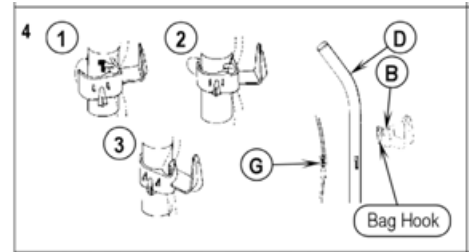

**4. Attach Lower Cord Hook** - Insert the power cord into the lower cord hook (C) (Figure 3). Snap the hook into the lower handle. Pull the cord up to tighten but leave enough slack near the base so the cord is not strained when the handle is lowered. Wrap the cord around the two cord hooks. Fasten the plug to the cord to prevent unwinding.

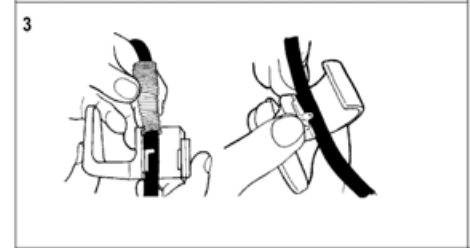

**5. Attach Filter Bag** - Position the filter bag adapter clip (H) on the bottom of the filter bag collar and inside the bag adapter retainer (I) below the air outlet. Push the bag collar up and forward so the locator tab (J) to the right of the cam latch (L) slides and engages into the slot (K), then turn the cam latch to lock the bag onto the shoulder rivet (M). To support the bag, loop the spring (N) from the top of the bag onto the bag support, located to the back of the upper cord hook (B) (Figure 2).

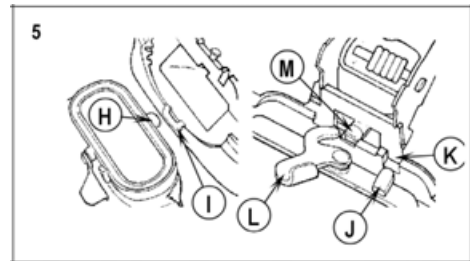

## MACHINE OPERATION

**6. Power Switch** - The power switch is located at the left rear of machine. Use foot to step on power switch to turn machine on or off.

**7. Handle Adjustment** - The handle lock is located at the left rear side of the machine. Use foot to step on handle lock to release and move handle to one of three positions.

**8. Height Adjustment** - This machine has a 6-position carpet height adjustment knob. To select the proper setting, start by moving the knob to the highest setting. Turn down one setting at a time until the machine's sound changes to a smooth buzzing or vibrating tone. This is the sound of the beater bars grooming the pile. Raising the front of the machine will make it easier to change settings.

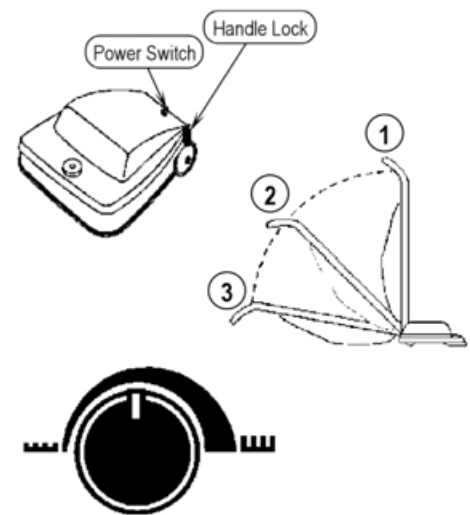

**Emptying Cloth Bag** - The cloth bag should be emptied frequently for maximum performance. To empty cloth bag, disconnect power cord from electrical wall outlet. Slide top of bag out of clamp, remove bottom by pulling back on lever arm on bag collar. Dump contents into a waste container and shake to remove stubborn dust. Reinstall bag on machine.

**NOTE:** It is not necessary to remove top clamp from machine.

**Replacing Disposable Paper Filter Bags (models with zipper bag)** - Disconnect power cord from wall outlet. Unzip the cloth bag and pull the plastic bag throat out of the bag's top fill sleeve and move coil spring down on throat. Remove full paper bag and dispose. Slide a new disposable paper filter bag on the plastic bag throat. Move coil spring up until it stops and paper bag is secure. Zip up cloth bag.

**IMPORTANT:** For optimum vacuum performance, the disposable paper filter bag should be changed frequently.

---

## MAINTENANCE

---

### Brush Roll Belt Replacement

**CAUTION!** Belt and pulley become hot during normal use.

The belt should be checked regularly to ensure proper cleaning. Replace belt if it appears stretched, cracked or is slipping. Remove bottom chrome plate by turning the two cam locks on each side. Remove worn belt from drive motor pulley. Remove brush roll from base, and slide off worn belt. Slip new belt around brush roll and reinstall into machine. Install belt around drive pulley with low side in groove. Be sure belt is installed correctly or brush roll will turn in wrong direction. Replace chrome cover. **NOTE:** Be sure brush roll with offset belt drive is orientated correctly, with the shorter length to the left. Arrows on brush roll end caps indicates the top of cap and shows installation direction. Cut away any hair or thread wound around the brush roll or the belt pulley because the buildup could cause the belt to rotate unevenly.

### Brush Strip Replacement

Remove the bottom chrome plate by turning the two cam locks on each side and remove brush roll from machine. Also remove nuts and end caps. Slide out worn brush strips and replace. Reassemble brush roll and reinstall in machine.

**NOTE:** Brush strips come in different lengths. See arrow markings on brush roll end caps to confirm direction of brush strips.

### Fan Scroll

The clear plastic fan scroll attached to the underside of the base may be removed and cleaned. Remove the chrome plate and brush roll belt from pulley. Remove the two screws on either side of the clear scroll, press the cam locks outward and lift the scroll from the base. Remove any dirt and/or obstructions. Be sure the gasket is in place and the scroll is seated properly before reattaching, then reinstall belt and chrome plate.

### Carbon Motor Brush Replacement

Once a year or after 500 operating hours, have the motor carbon motor brushes replaced. Failure to service carbon motor carbon brushes will null and void warranty.

---

## LIMITED WARRANTY

---

The vacuum cleaner is warranted for 1 year from the date of purchase. Parts not covered under warranty are power cords, filters, motor brushes and blades. The warranty covers only failure due to defective parts or workmanship and will be invalidated by improper application and abuse.

Under no circumstances should you return a failed unit to the factory. If you experience any problems with your vacuum during the warranty period, contact the Customer Service Department.

# IMPORTANT SAFETY INSTRUCTIONS

When using an electrical vacuum, basic safety precautions should always be followed, including the following:

## READ ALL INSTRUCTIONS BEFORE USING YOUR VACUUM CLEANER

**WARNING:** To reduce the risk of fire, electrical shock, or injury:

1. Do not leave appliance when plugged in. Unplug from outlet when not in use and before servicing.
2. Do not expose to rain. Store indoors.
3. Do not allow to be used as a toy. Close attention is necessary when used by or near children.
4. Use only as described in this manual. Use only manufacturer's recommended attachments.
5. Do not use with damaged cord or plug. If appliance is not working as it should, has been dropped, damaged, left outdoors, or dropped into water, contact Customer Service.
6. Do not pull or carry by cord, use as a handle, close a door on cord, or pull cord around sharp edges or corners. Do not run appliances over cord. Keep cord away from heated surfaces.
7. Do not unplug by pulling on cord. To unplug, grasp the plug, not the cord.
8. Do not handle plug or appliance with wet hands.
9. Do not put any object into openings. Do not use with any opening blocked; keep free of dust, lint, hair and anything that may reduce air flow.
10. Keep hair, loose clothing, fingers and all parts of the body away from openings and moving parts.
11. Do not pick up anything that is burning or smoking, such as cigarettes, matches, or hot ashes.
12. Do not use without dust bag and/or filters in place.
13. Turn off all controls before unplugging.
14. Use extra care when cleaning on stairs.
15. Do not use to pick up flammable or combustible liquids such as gasoline, or use in areas where they may be present.
16. This vacuum is for commercial use only.
17. Connect to a properly grounded outlet only. See grounding instructions.

## SAVE THESE INSTRUCTIONS

**GROUNDING INSTRUCTIONS** - This appliance must be grounded. If it should malfunction or breakdown, grounding provides a path of least resistance for electric current to reduce the risk of electric shock. This appliance is equipped with a cord having equipment grounding conductor and grounding plug. The plug must be inserted into an appropriate outlet that is properly installed and grounded in accordance with all local codes and ordinances.

**WARNING:** Improper connection of the equipment grounding conductor can result in a risk of electric shock. Check with a qualified electrician or service person if you are in doubt as to whether the outlet is properly grounded.

Do not modify the plug provided with the appliance - if it will not fit the outlet, have a proper outlet installed by a qualified electrician.

This appliance is for use on a nominal 120 - Volt circuit, and has a grounded plug that looks like the plug illustrated in sketch A below. A temporary adapter that looks like the adapter illustrated in sketches B and C may be used to connect this plug to a 2-pole receptacle as shown in sketch B if a properly grounded receptacle is not available. The temporary adapter should be used only until a properly grounded outlet (sketch A) can be installed by a qualified electrician. The green colored ear, lug, or the like extending from the adapter must be connected to a permanent ground such as a properly grounded outlet box cover. Whenever the adapter is used, it must be held in place by a metal screw.

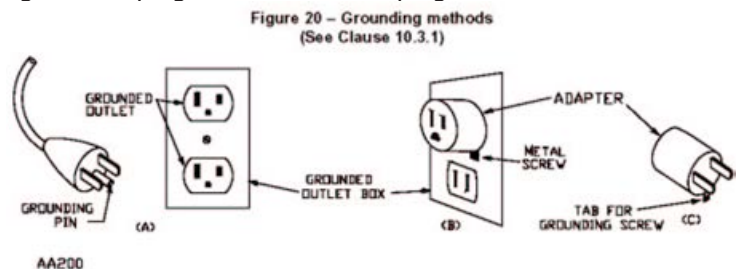

NOTE: In Canada, the use of a temporary adapter is not permitted by the Canadian Electrical Code.

# IMPORTANTES CONSIGNES DE SECURITE

L'utilisation d'un appareil électrique demande certaines précautions:

## LIRE TOUTES LES INSTRUCTIONS AVANT DE FAIRE FONCTIONNER CET APPAREIL

**AVERTISSEMENT:** Pour réduire les risques d'incendie, de choc électrique ou de blessure:

1. Ne pas laisser l'appareil sans surveillance lorsqu'il est branché. De brancher lorsque l'appareil n'est pas utilisé et avant l'entretien.
2. Ne brancher qu'à une prise de courant avec mise à la terre. Voir les instructions visant la mise à la terre.
3. Ne pas permettre aux enfants de jouer avec l'appareil. Une attention particulière est nécessaire lorsque l'appareil est utilisé par des enfants ou à proximité de ces derniers.
4. N'utiliser que conformément à cette notice avec les accessoires recommandés par le fabricant.
5. Ne pas utiliser si le cordon ou la fiche est endommagé. Retourner l'appareil à un atelier de réparation s'il ne fonctionne pas bien, s'il est tombé ou s'il a été endommagé, oublié à l'extérieur ou immergé.
6. Ne pas tirer, soulever ou trainer l'appareil par le cordon. Ne pas utiliser le cordon comme une poignée, le coincer dans l'embrasure d'une porte ou l'appuyer contre des arêtes vives ou des coins. Ne pas faire rouler l'appareil sur le cordon. Garder le cordon à l'écart des surfaces chaudes.
7. Ne pas débrancher en tirant sur le cordon. Tirer plutôt la fiche.
8. Ne pas toucher la fiche ou l'appareil lorsque vos mains sont humides.
9. N'insérer aucun objet dans les ouvertures. Ne pas utiliser l'appareil lorsqu'une ouverture est bloquée. S'assurer que de la poussière, de la peluche, des cheveux ou d'autres matières ne réduisent pas le débit d'air.
10. Maintenir les cheveux, les vêtements amples, les doigts et toutes les parties du corps à l'écart des ouvertures et des pièces mobiles.
11. Ne pas aspirer de matières en combustion ou qui dégagent de la fumée, comme des cigarettes, des allumettes ou des cendres chaudes.
12. Ne pas utiliser l'appareil si le sac à poussière ou le filtre n'est pas en place.
13. Mettre toutes les commandes à la position ARRÊT avant de débrancher l'appareil.
14. User de prudence lors du nettoyage des escaliers.
15. Ne pas aspirer des liquides inflammables ou combustibles, comme de l'essence, et ne pas faire fonctionner dans des endroits où peuvent se trouver de tels liquides.
16. Avertissement- Pour réduire les risques de choc électrique, ne pas exposer à la pluie et garder l'aspirateur à l'intérieur.
17. Appareils mis à la terre: "Ne brancher qu'à une prise de courant avec mise à la terre. Voir les instructions visant la mise à la terre.

## CONSERVER CES INSTRUCTIONS

**INSTRUCTIONS VISANT LA MISE À LA TERRE** - Cet appareil doit être mis à la terre. En cas de défaillance ou de panne éventuelles, la mise à la terre fournit au courant un chemin de moindre résistance qui réduit le risque de choc électrique. Cet appareil est pourvu d'un cordon muni d'un conducteur de terre et d'une fiche avec broche de terre. La fiche doit être branchée dans une prise appropriée correctement installée et mise à la terre conformément aux règlements et ordonnances municipaux.

**AVERTISSEMENT:** Un conducteur de terre mal raccordé peut entraîner un risque de choc électrique. Consulter un électricien ou un technicien d'entretien qualifié si vous n'êtes pas certain que la prise est correctement mise à la terre. Ne pas modifier la fiche fournie avec l'appareil - si elle ne peut être insérée dans la prise, faire installer une prise adéquate par un électricien qualifié.

Cet appareil est destiné à un circuit de 120 V et est muni d'une fiche de mise à la terre semblable à celle illustrée par le croquis A de la figure. S'assurer que l'appareil est branché à une prise de courant ayant la même configuration que la fiche. Aucun adaptateur ne devrait être utilisé avec cet appareil.

La mise à la terre selon les croquis B et C n'est pas permise au Canada.

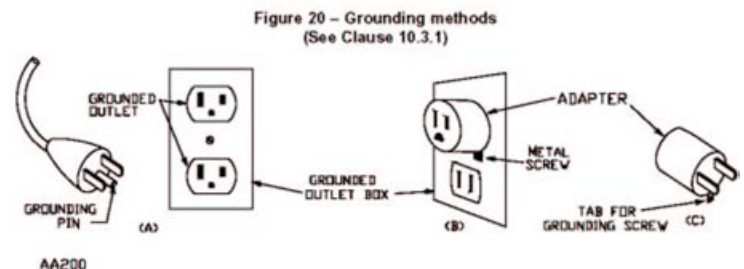

7545 Irvine Center Dr., Ste. 200 • Irvine, CA 92618  
Toll Free: 844 VACS R US or 844-822-7787 • Fax: 949-623-8305  
SterlingNA.com